

2225-2

Ground Floor layout

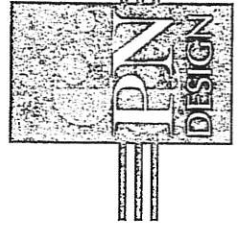
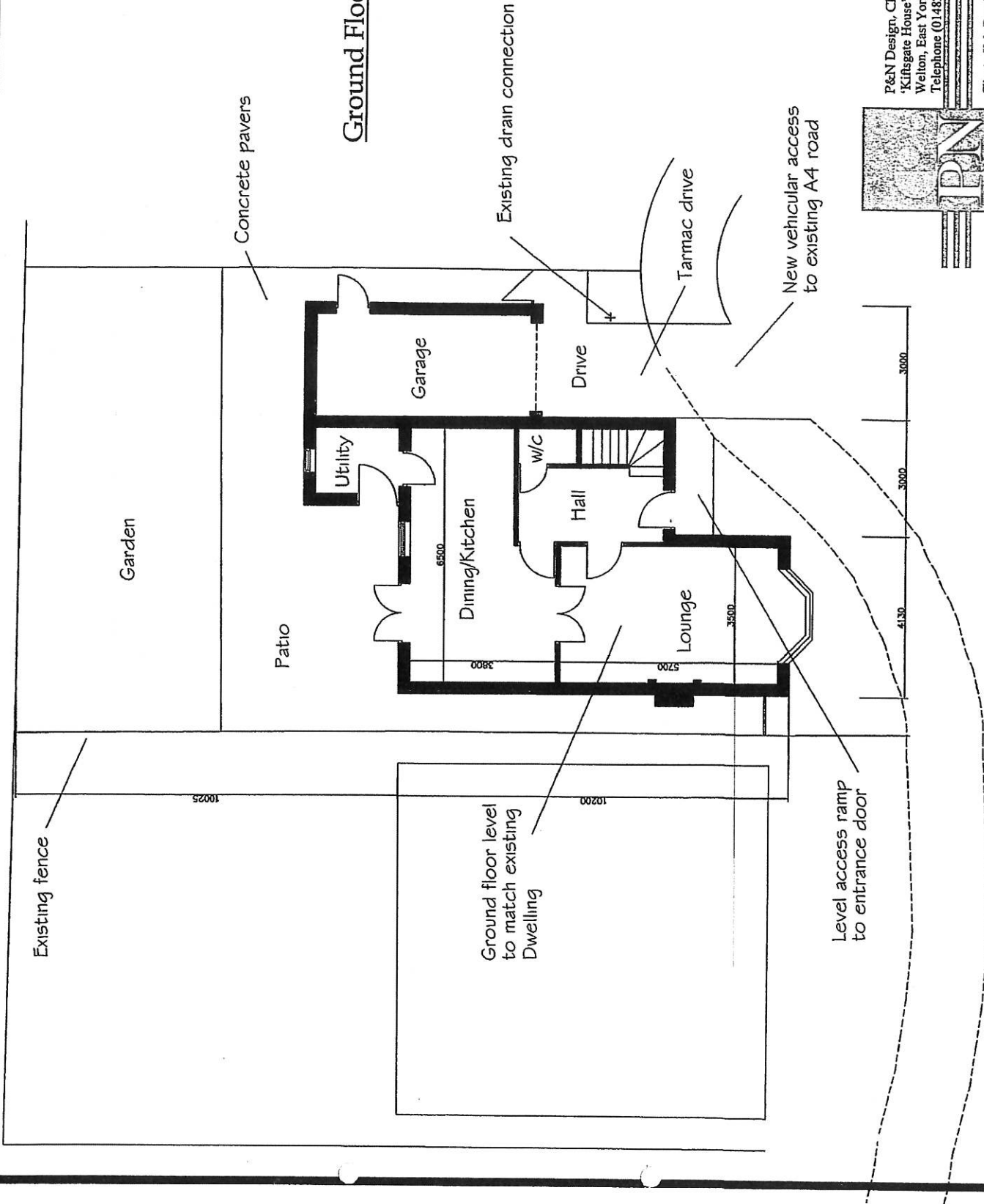

P&N Design, Chartered Architectural Technologists
 'Kittsgate House', Waulby Manor Farm, Beverley Road
 Welton, East Yorkshire, HU15 1QR
 Telephone (01482) 665551 fax (01482) 665548
 17 DEC 2007

Client: Vale Developments
 Project: Proposed new dwelling
 Site: Plot 3, Jubilee Close, Hedon
 Date: 27.11.2007
 Scale: 1:100
 Dwg.No: 2225-2